

LEGEND	
-X-X-	Barbed Wire
SS	Sanitary Sewer
FH	Fire Hydrant
PP	Power Pole
IPP	Iron Pin Placed
IPF	Iron Pin Found
MON	Monument
LP	Light Pole
EP	Edge Pavement
OTP	Open Top Pin
CMT	Crimp Top Pin
B/C	Back of Curb
CL	Centerline
○-○-○	Chain Link Fence
SMH	Sewer Manhole
SSE	Sanitary Sewer Easement
JB	Junction Box
DI	Drop Inlet
PL	Property Line
CMP	Corrugated Metal Pipe
RCP	Reinforced Concrete
DE	Drainage Easement
WV	Water Valve
WM	Water Meter
R/W	Right of Way
—	Power Line

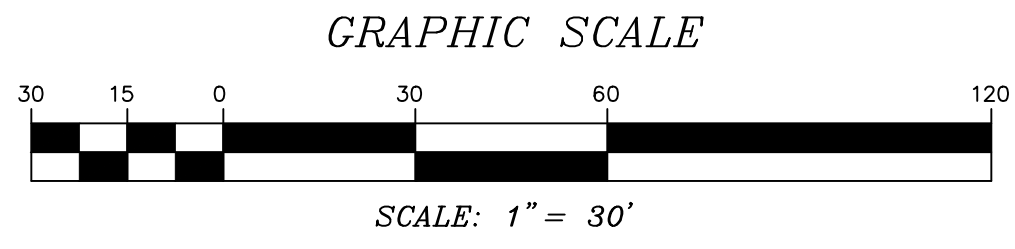

ALL IRON PINS ARE 1/2" REBAR UNLESS OTHERWISE NOTED.

EQUIPMENT USED FOR MEASUREMENTS:  
 ANGULAR - TOPCON GTS-300 TOTAL STATION  
 LINEAR - EDM

THE FIELD DATA UPON WHICH THIS PLAT IS BASED HAS A CLOSURE PRECISION OF ONE FOOT IN 25,000 FEET, AND AN ANGULAR ERROR OF 03 SECONDS PER ANGLE POINT.

ALL ELEVATIONS ARE BASED UPON MEAN SEA LEVEL.

THIS PLAT SUBJECT TO ALL EASEMENTS AND RIGHTS OF WAY PUBLIC AND PRIVATE.

BEARINGS SHOWN ARE BASED ON ONE MAGNETIC OBSERVATION AND ANGLES TURNED.

IN MY OPINION THIS PLAT OR SURVEY IS A CORRECT REPRESENTATION OF THE LAND PLATTED AND HAS BEEN PREPARED IN CONFORMITY WITH THE MINIMUM STANDARDS AND REQUIREMENTS OF THE LAW.

Kenneth L. Nutt, Reg. Land Surveyor #2104

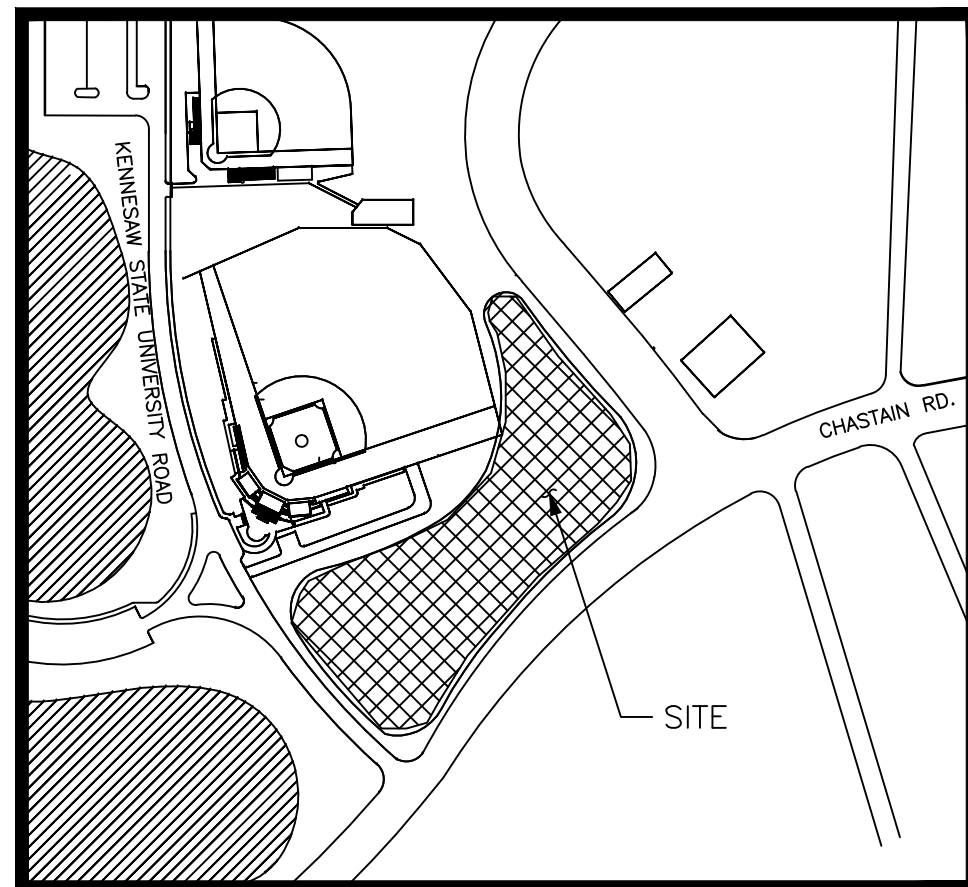

SITE LOCATION MAP

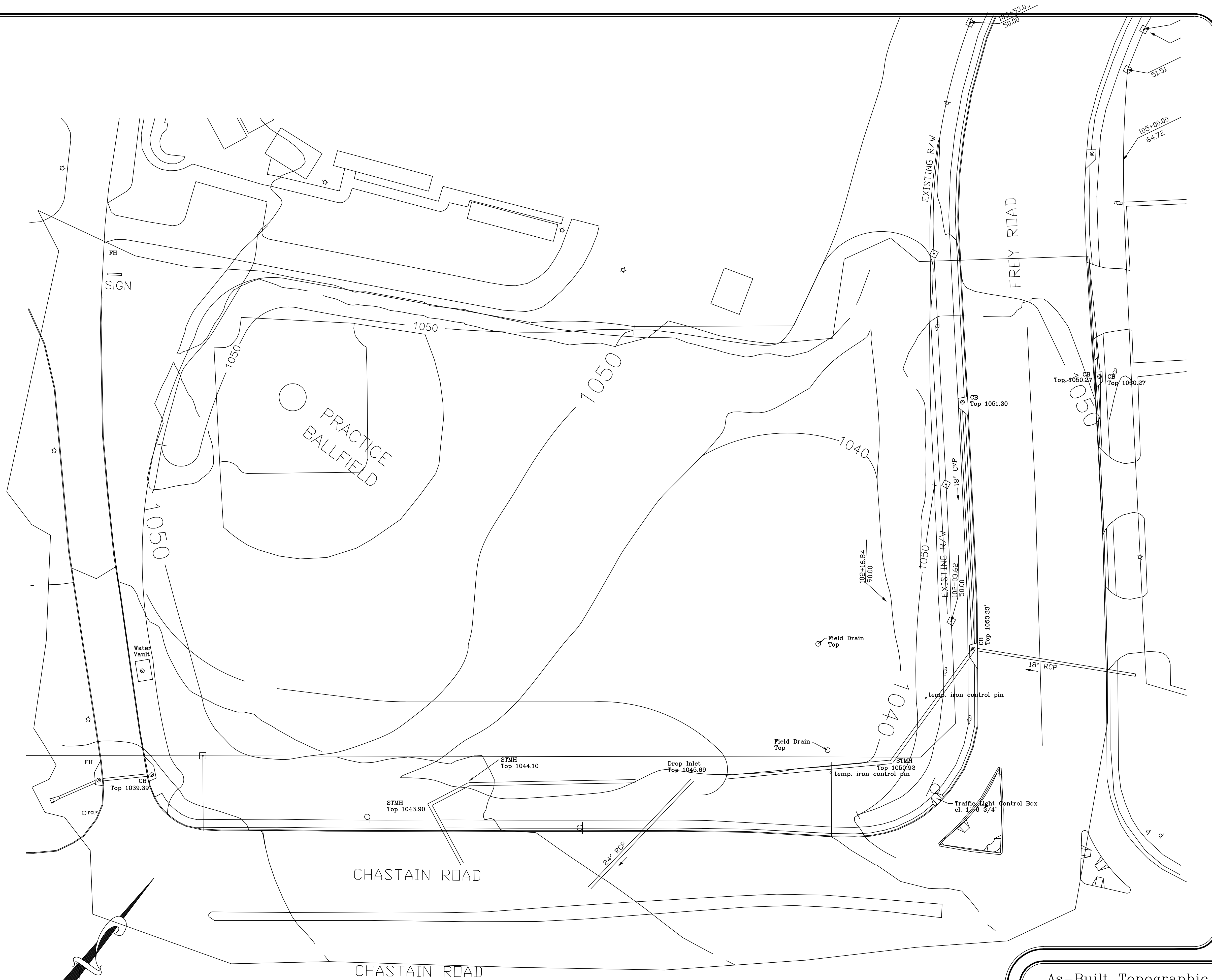

**KEN NUTT, L.L.C.**  
 1065 Sandtown Road, S.W. Marietta, GA 30008  
 Phone: (770) 425-6824 Fax: (770) 425-6768

Job #: 029700  
 File: jones2

TITLE: AS-BUILT TOPOGRAPHIC SURVEY FOR  
 Kennesaw State University  
 PROJECT: 1000 Chastain Road  
 Kennesaw, Georgia 30144

As-Built Topographic Survey for  
 Kennesaw State University

Land Lots 96, 97, 132, 133 20th Dist.

2nd Sect., Cobb County, Georgia

Date: 9/11/00 Sheet 1 of 1

Computed by: MDG Party Chief: KLN  
 Drawn by: MDG Date Surveyed: 9/10/00  
 Checked by: KLN Date Drawn: 9/11/00

KSU Proj. #00-0032

Flood Note  
 According to F.I.R.M. Community Panel Number 13067 C0030 F dated 8/18/92, this property is located in an area having special flood hazards.